

N4说明书 正面折页



User's Manual

Features:

- 1080P Full HD image sensor network camera
- Support WIFI connection
- Support two way audio
- Motion detection Alert, mobile phone can receive msg once object moving
- HD video and image no matter Day/Night

A. Packaging Details

After opening the package, please make sure the camera is in good condition, confirm below accessories are complete or not.

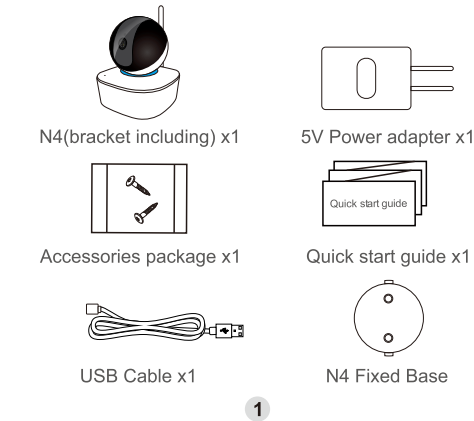

1

Home Security Camera

B. Appearance Description

RESET

Press the reset button, reset it to factory default setting.

SD Card

Support SD card local storage (Max 128G, Format FAT32).

Please format the sd card before insert it.

Power adapter

5V-1A.

Speaker

Support two way audio and voice prompt.

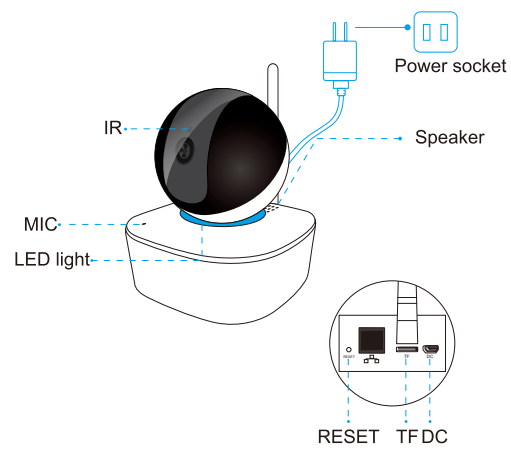

2

Home Security Camera

C. Installation

1. Install the bracket

Fix the plastic wall plug on the installing place, put the bracket on then tighten it up with screws, finish the bracket installation.

2. Install the camera

Put the camera onto the fixed bracket, as shown in figure below. You can loose the screw of the adjustable part of bracket, then adjust it until you find the viewing angle you want, then finally make it fixed.

Notice: If install outdoors and choose to connect with net cable, please remember to set the waterproof accessories on the cable port before using.

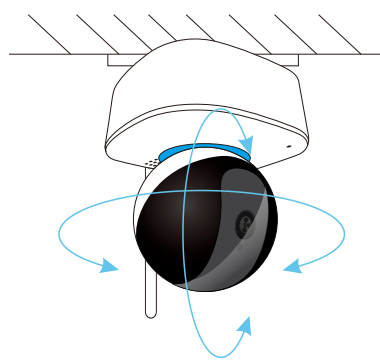

3

Home Security Camera

D. Download the APP

Scan the QR code or search FINDCAM Max APP in APP Store or Google Play.



FINDCAM Max



4

Home Security Camera

E. Wired Configuration

1. Connect the device with network cable, make sure your phone and device in same LAN. Enter the APP, click "+" to add new device.

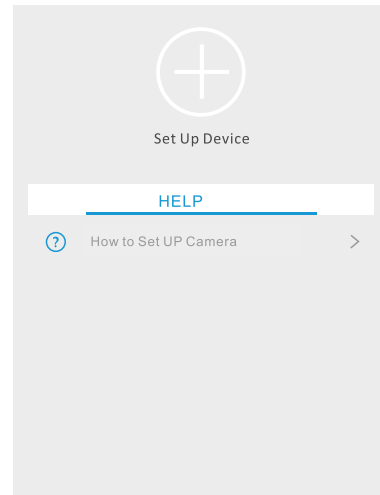
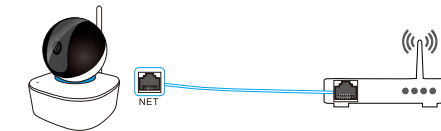

5

Home Security Camera

2. Scan the QR code on device.



Scan the QR code



Scan the QR code on your device

HELP ME FIND MY CODE

SET UP WITHOUT SCANNING

6

Home Security Camera

3. Add device, create device name and enter login password. Default password is admin.

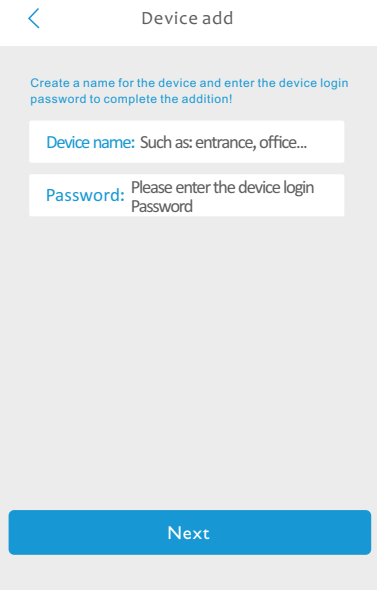

7

N4 说明书 背面折页

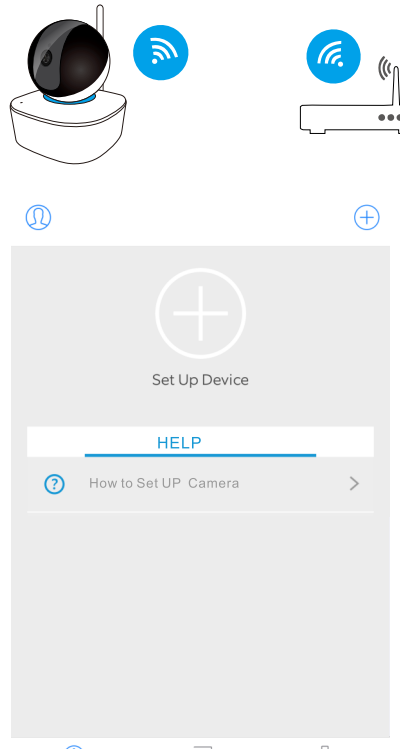
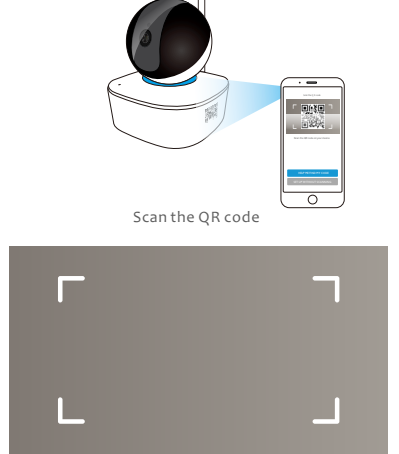
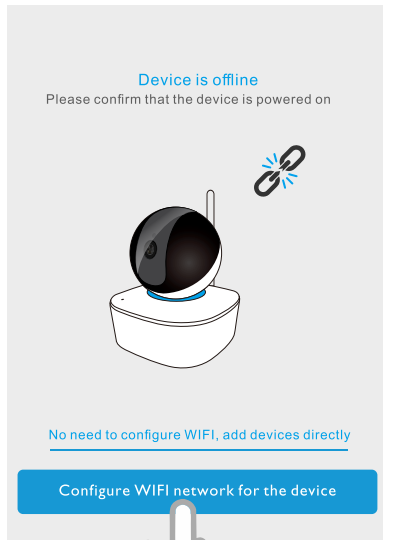
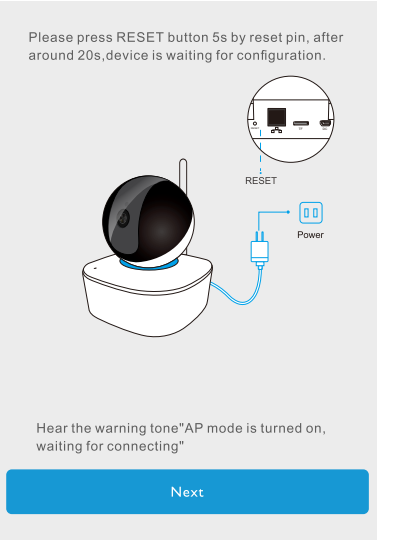
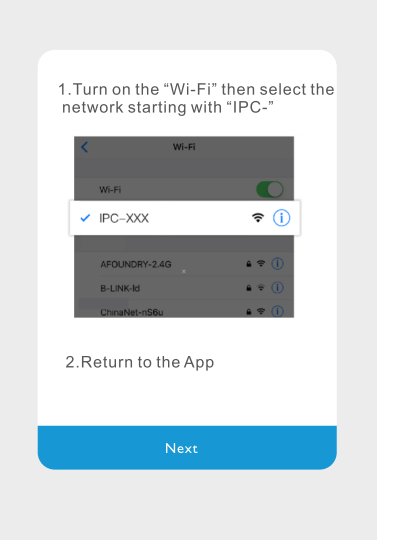
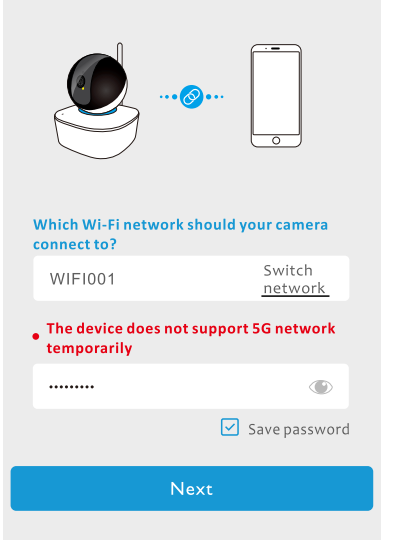
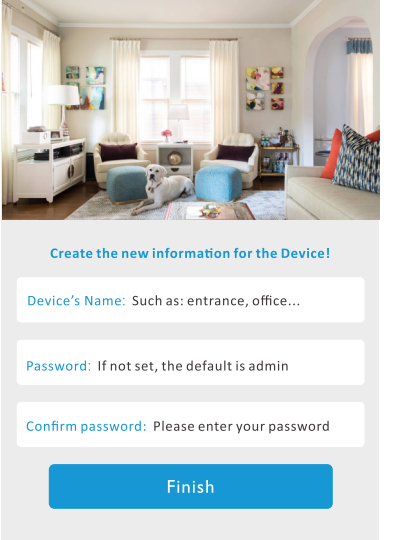
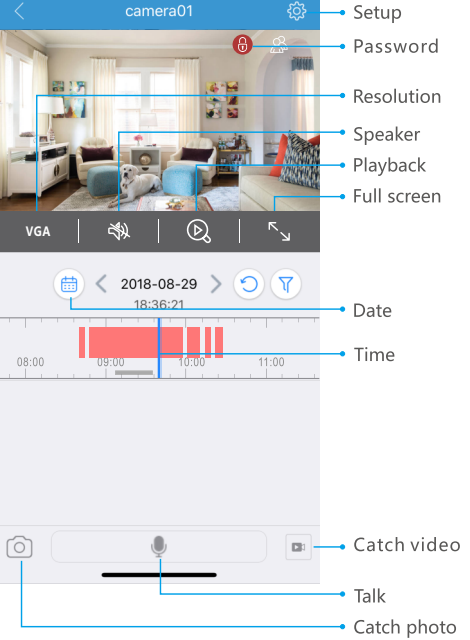
<p>Home Security Camera</p> <p>F: Wifi configuration.</p> <p>1. Enter the APP, click "+" to add new device.</p>  <p>8</p>	<p>Home Security Camera</p> <p>2. Scan the QR code on device.</p>  <p>9</p>	<p>Home Security Camera</p> <p>3. The device will show offline if first time using. Please confirm the device is power-on, then configure Wi-Fi network for it.</p>  <p>10</p>	<p>Home Security Camera</p> <p>4. Please press the reset button till the reset reminder tone -" Reset to factory setting " on. Then the device needs about 20s to enter the AP mode.</p>  <p>11</p>	<p>Home Security Camera</p> <p>5. Turn on the Wi-Fi setting of your phone, select the one with name starting as "IPC-" and connect it. Then back to the app.</p>  <p>12</p>	<p>Home Security Camera</p> <p>6. Choose the Wi-Fi the device will connect to , fill in the Wi-Fi password. Click to " Next " , the device will receive the configure information then begin to connect .</p>  <p>13</p>	<p>Home Security Camera</p> <p>7. After the remind tone - " The connection is successful " on, the device has completed the configuration. Add device, create device name and password.</p>  <p>14</p>	<p>Home Security Camera</p> <p>8. Access the device from your mobile phone.</p>  <p>15</p>
---	--	---	--	---	---	---	---